

INSTRUCTION MANUAL



KEPCO An ISO 9001 Company.

CA 35-R
COVER

ENCLOSURES AND HARDWARE SYSTEMS

DESCRIPTION. The Kepco Model CA 35-R, RoHS-compliant Cover (see Figure 1) is supplied for use with Kepco Series RKW 100 Watt power supplies. The cover includes one 4-40 x 0.25 in. long thread-forming screw (Kepco P/N 101-0470) used to attach the cover to the power supply as shown in Figure 1; the other mounting screw is part of the RKW power supply. These screws must not be overtightened (max. torque 10 in.- lbs (1.1 N x m). Refer to Figure 2 for outline dimensions.

INSTALLATION. Remove screw from RKW power supply shown in Figure 1. Slide the cover onto power supply so that the tabs are aligned as shown in Detail A and secure with two screws as shown in Figure 1.

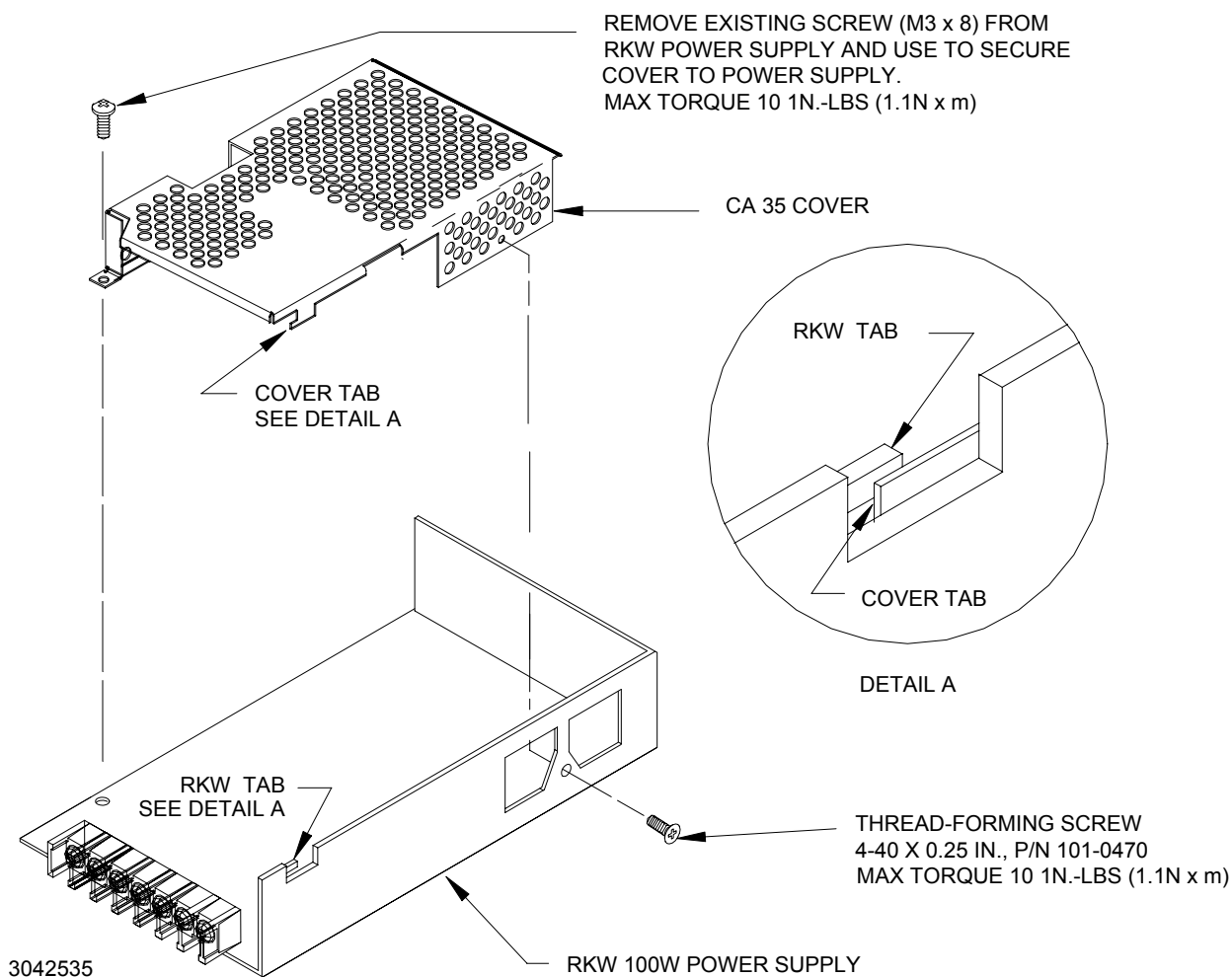
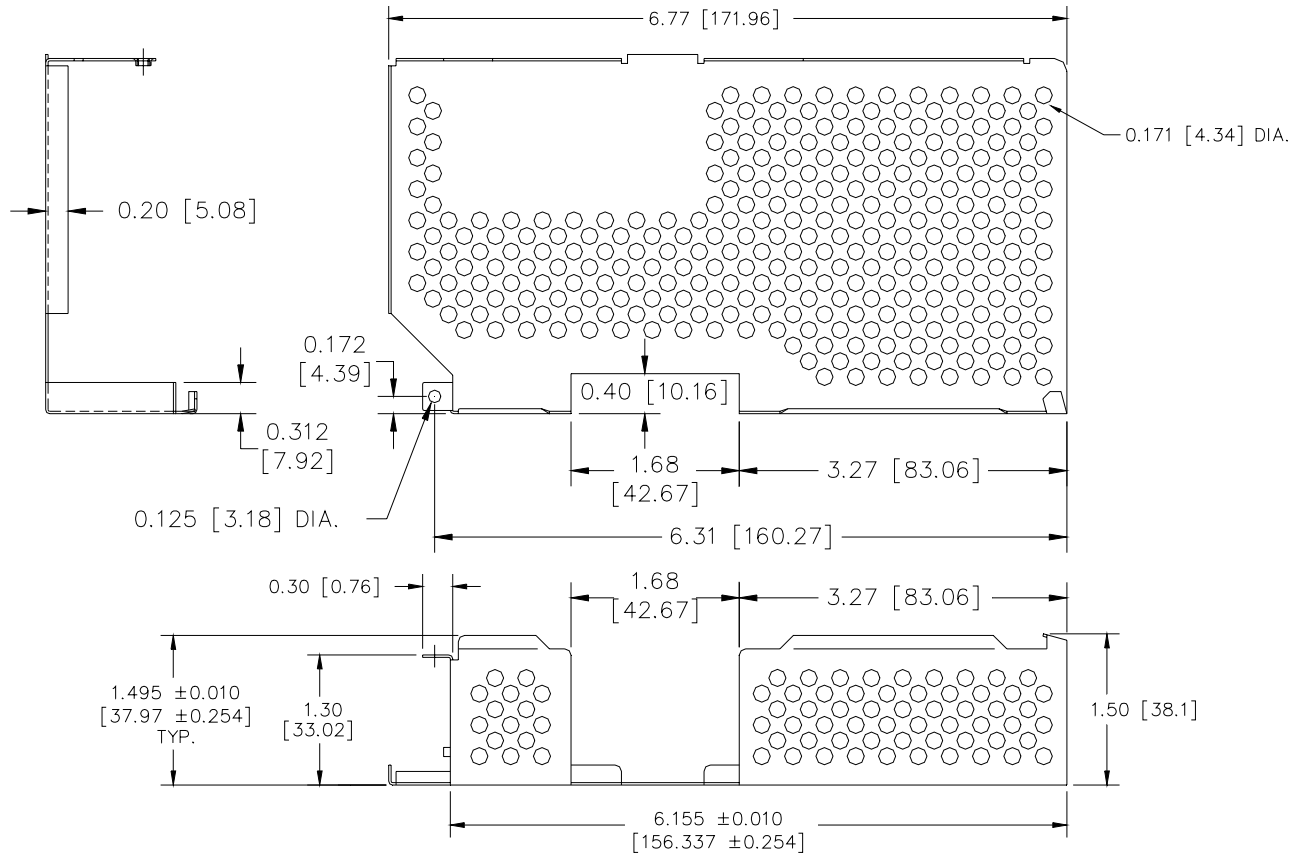

FIGURE 1. CA 35-R COVER INSTALLATION

KEPCO, INC. ● 131-38 SANFORD AVENUE ● FLUSHING, NY. 11352 U.S.A. ● TEL (718) 461-7000 ● FAX (718) 767-1102
<http://www.kepcopower.com> ● email: hq@kepcopower.com



NOTES:

1. DIMENSIONS: IN INCHES; DIMENSIONS IN BRACKETS ARE IN MILLIMETERS.
2. TOLERANCES: ±0.04 [±1] UNLESS OTHERWISE SPECIFIED.
3. MATERIAL: 0.024 [0.6] COLD ROLLED STEEL.
4. FINISH: RoHS COMPLIANT ZINC WITH CLEAR WASH.

3043185

FIGURE 2. CA 35-R OUTLINE DIMENSIONS